

GMN 微型綫性系列導軌尺寸表

Dimensions for SHAC GMN Series Miniature Linear Guideways

GMN-C / GMN-H

GMN5

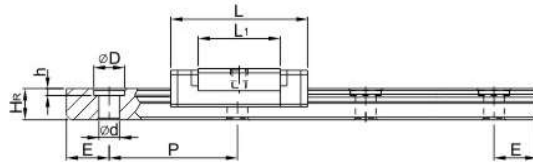
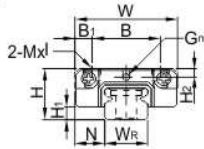

GMN7, GMN9, GMN12

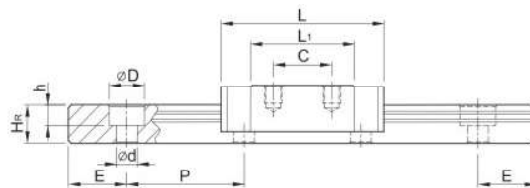
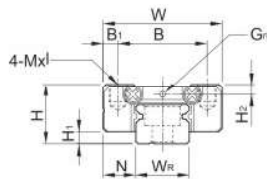

GMN15

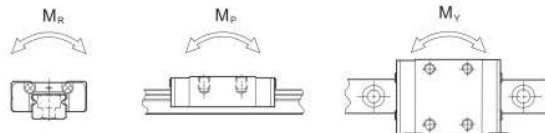
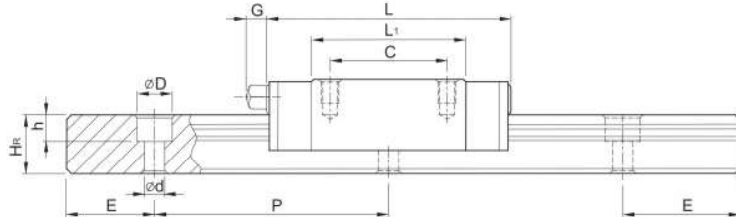
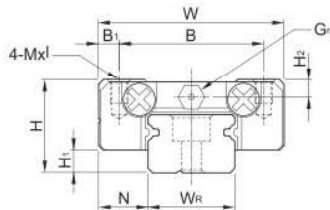

型號 Model No.	組件尺寸 (mm) Dimensions of Assembly			滑塊尺寸 (mm) Dimensions of Block										滑軌尺寸 (mm) Dimensions of Rail						滑軌固定 螺栓尺寸 Mounting Bolt for Rail	額定動 載核 Basic Dynamic Load Rating	額定靜 載核 Basic Static Load Rating	容許靜力矩 Static Rated Moment (kgf.m)			重量 Weight		
	H	H ₁	N	W	B	B ₁	C	L ₁	L	G	G _n	Mxl	H ₂	W _R	H _R	D	h	d	P				E	M _R	M _p	M _y	滑塊 Block	滑軌 Rail
	mm	mm	mm	mm	mm	mm	mm	mm	mm	mm	mm	mm	mm	mm	mm	mm	mm	mm	mm				mm	N-m	N-m	N-m	kg	kg/m
GMN5C	6	1.5	3.5	12	8	2	-	9.6	16	-	∅0.8	M2x1.5	1	5	3.6	3.6	0.8	2.4	15	5	M2x6	0.54	0.84	2	1.3	1.3	0.008	0.15
GMN 7C	8	1.5	5	17	12	2.5	8	13.5	22.5	-	∅1.2	M2x2.5	1.5	7	4.8	4.2	2.3	2.4	15	5	M2x6	0.98	1.24	4.70	2.84	2.84	0.010	0.22
GMN 7H							13	21.8	30.8													1.37	1.96	7.64	4.80	4.80	0.015	
GMN 9C	10	2	5.5	20	15	2.5	10	18.9	28.9	-	∅1.4	M3x3	1.8	9	6.5	6	3.5	3.5	20	7.5	M3x8	1.86	2.55	11.76	7.35	7.35	0.016	0.38
GMN 9H							16	29.9	39.9													2.55	4.02	19.60	18.62	18.62	0.026	
GMN 12C	13	3	7.5	27	20	3.5	15	21.7	34.7	-	∅2	M3x3.5	2.5	12	8	6	4.5	3.5	25	10	M3x8	2.84	3.92	25.48	13.72	13.72	0.034	0.65
GMN 12H							20	32.4	45.4													3.72	5.88	38.22	36.26	36.26	0.054	
GMN 15C	16	4	8.5	32	25	3.5	20	26.7	42.1	4.5	M3	M3x4	3	15	10	6	4.5	3.5	40	15	M3x10	4.61	5.59	45.08	21.56	21.56	0.059	1.06
GMN 15H							25	43.4	58.8													6.37	9.11	73.50	57.82	57.82	0.092	

註 : 1 kgf = 9.81 N